

# RT, CABLE PULLER

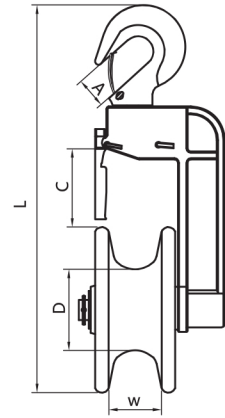

RT

- ← High strength brass by casting
- ← High strength aluminium alloy by casting
- ← High strength aluminium alloy by casting finished with epoxy resin



Type	Dimensions(mm)					Failure Load (kN)	Pack (pcs)
	L	D	W	A	C		
RT-1	355	78	54	33	60	8	1x8
RT-2	465	134	64	33	80	8	1x2
RT-3	465	252	43	33	55	8	1x2